

MyCSU Android Application Manual

Part 1: Getting started in the MyCsu android app.

Step 1: Install the downloaded apk file.

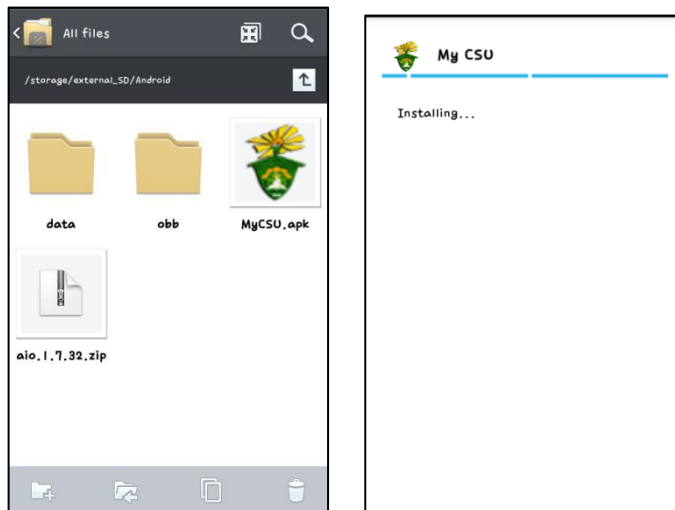

Step 2: The user may log-in using his/her CSU account. The **settings** button beside the log-in button let the user change the uri where the app connects to access the CSU server. It is better for the user to not change the uri unless he/she is told to.



Part 2: Using the Services.

The image below shows the 6 services the user can use in this android app. The student can access the services in the main page menu and in the navigation menu that also provide the users basic information (shown below).

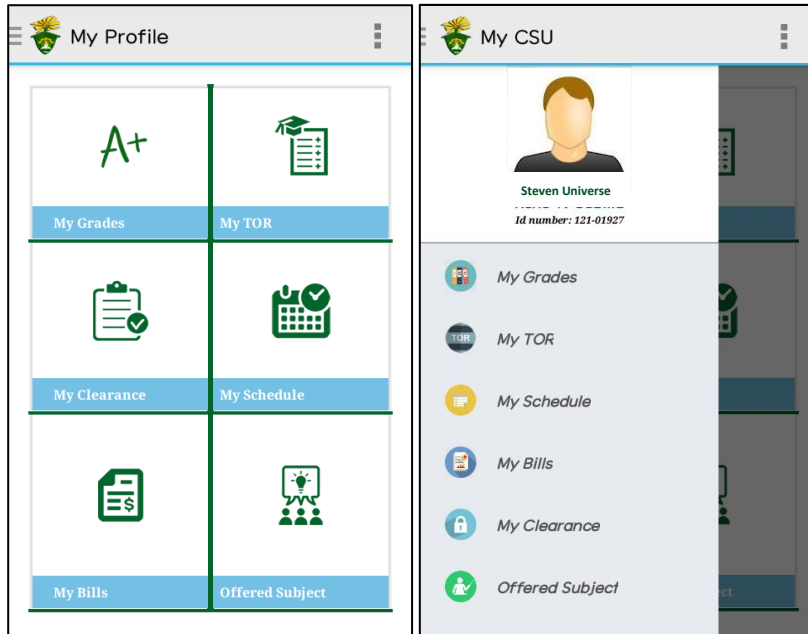

The main page menu

Navigation menu

- **My Grades**- Display the grades of the student, given the school year and semester
- **My TOR**- Displays all the students' grades from his/her first year, first semester until his/her most current set of grades.
- **My Clearance**- Displays the clearance status of the student, given the semester and school year.
- **My Schedule**-Displays the students schedule, given the semester and school year.
- **My Bills** – Displays the students assessment record including his/her payment history, current balance and total payables, given the semester and school year
- **Offered Subject**- Displays the offered subject, its schedule and room assignments needed by the students, given the subject code, school year and semester the offered subject is desired.

A. My Grades

Provide the **school year** and **semester** then tap the search button to display the grades needed. If the user wants to know if his/her INC has been complied, just tap the grade with the INC.

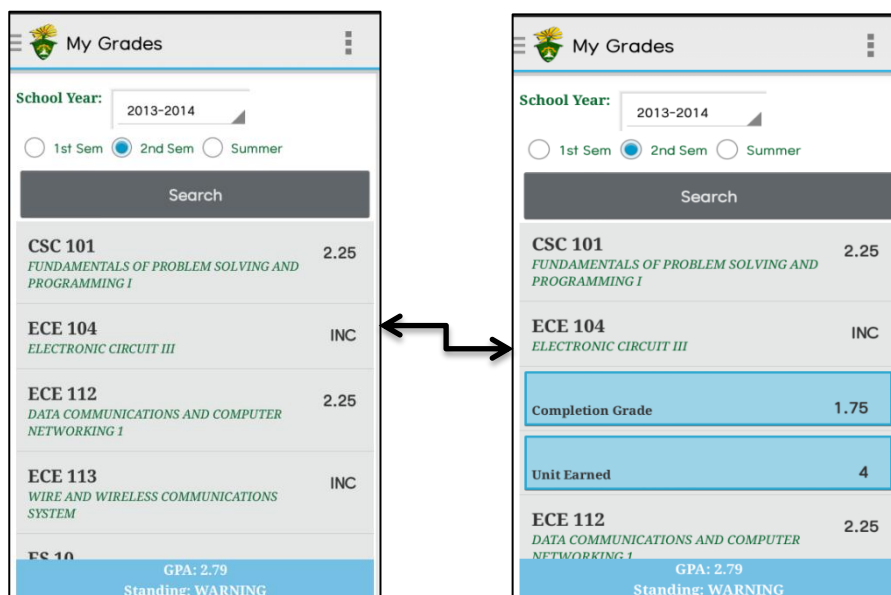

B. My TOR

This service displays the entire grade record of the student. When the Semester text is clicked the entire grade for that semester will collapse for a better user experience.

My TOR			
School Year: 2012-2013 , 1st Sem			
ELECTRIC CIRCUIT THEORY I			
EE 101	FG: 3.00	CG: 0.0	Units: 4
VECTOR ANALYSIS			
ES 16	FG: 2.75	CG: 0.0	Units: 3
BASIC DRAWING			
ES 1	FG: DROP	CG: 0.0	Units: 2
DIFFERENTIAL EQUATION FOR ENGINEERS			
ES 3	FG: 2.50	CG: 0.0	Units: 3
PROB. AND STAT FOR SCIENTISTS AND TECHNOLOGIES			
ES 8	FG: 2.75	CG: 0.0	Units: 3
PLANE AND SPHERICAL TRIGONOMETRY			
MATH 2.1	FG: 1.75	CG: 0.0	Units: 3
PHYSICAL FITNESS			
PE 1	FG: INC	CG: 0.0	Units: 2
School Year: 2012-2013 , 2nd Sem			
FG- Final Grade, CG- Compilation Grade			

My TOR			
School Year: 2012-2013 , 1st Sem			
School Year: 2012-2013 , 2nd Sem			
ELECTRONIC DEVICES AND CIRCUITS (ELECTRONIC CIRCUIT 1)			
ECE 101	FG: INC	CG: 3.0	Units: 4
ELECTROMAGNETICS			
ECE 105	FG: 2.75	CG: 0.0	Units: 3
SIGNALS, SPECTRA, SIGNAL PROCESSING			
ECE 129	FG: INC	CG: 0.0	Units: 4
ELECTRIC CIRCUIT THEORY II			
EE 102	FG: INC	CG: 0.0	Units: 4
FUNDAMENTALS OF MATERIAL SCIENCE & ENGINEERING			
ES 11	FG: 2.50	CG: 0.0	Units: 3
DYNAMICS OF RIGID BODIES			
ES 5	FG: INC	CG: 3.0	Units: 3
FG- Final Grade, CG- Compilation Grade			

My TOR			
School Year: 2012-2013 , 1st Sem			
School Year: 2012-2013 , 2nd Sem			
School Year: 2013-2014 , 1st Sem			
School Year: 2013-2014 , 2nd Sem			
School Year: 2014-2015 , 1st Sem			
School Year: 2014-2015 , 2nd Sem			
School Year: 2014-2015 , Summer			
School Year: 2015-2016 , 1st Sem			
FG- Final Grade, CG- Compilation Grade			

C. My Clearance

Provide the **school year** and **semester** then tap the search button to display the clearance information needed. If the student has uncleared liabilities, it will be displayed with red background and in blue otherwise as seen below.

My Clearance

School Year: 2014-2015

☒ 1st Sem ☐ 2nd Sem ☐ Summer

Search

College Of Engineering And Information Technology

Posted By: ENGR. ALEXANDER T. DEMETILLO
Reason: Unsettled College Obligations
Remarks: UNPAID STUDENT LOANS
Date Blocked: 25 M 2015
Service Blocked:
Cleared at 14 A 2015

College Of Engineering And Information Technology

Posted By: ENGR. ALEXANDER T. DEMETILLO
Reason: Unsettled College Obligations
Remarks: Unpaid Acquaintance Payment
Date Blocked: 21 O 2014
Service Blocked:
Cleared at 05 N 2014

College Of Engineering And Information Technology

D. My Schedule

Provide the **school year** and **semester** then tap the search button to display the schedule needed. The student schedule can either be viewed in table form or in list form. The table form looks better if the user is using a tablet instead of a smart phone.

My Schedule

School Year: 2015-2016
☒ 1st Sem ☐ 2nd Sem ☐ Summer

Search

10:30am-11:00am	CSC 121COM ARCADE-C01-ARCADE 2	ES 143NB-REPAIR ROOM	CSC 15103
11:00am-11:30am			
11:30am-12:00pm			
12:00pm-12:30pm			
12:30pm-1:00pm			
1:00pm-1:30pm		ES 120M ARCADE-DRAWING RM	ES 120M ARCADE-DRAWING RM
1:30pm-2:00pm	ELECTIVE 2NGB-HITACHI LAB	ELECTIVE 2NGB-HITACHI LAB	ES 120M ARCADE-DRAWING RM
2:00pm-2:30pm			
2:30pm-3:00pm			

Show list of schedule

Table View

My Schedule

School Year: 2015-2016
☒ 1st Sem ☐ 2nd Sem ☐ Summer

Search

DATA STRUCTURE 1

CSC 121
 Section: CN1
 Schedule: MTh 10:30:00-11:30:00,TF 15:00:00-16:30:00
 Instructor: MARIA BESA JOY ORTUYO

DIGITAL CONTROL SYSTEM

ELECTIVE 2
 Section: BEFG1
 Schedule: M 13:30:00-16:30:00,MTh 09:00:00-10:30:00
 Instructor: YDRON PAUL AMARGA

Show Time table

List View

E. My Bills

Provide the **school year** and **semester** then tap the search button to display the school bills the user needed to know. There are two buttons right below the search button which are the subject load that displays the units the user is currently enrolled to and the assessment record button that displays the detailed school fees the user needs to pay. The last two sections display the payment history of the user and the account summary that displays the total payable, total payment and the users remaining balance.

My Bills

School Year: 2015-2016
☒ 1st Sem ☐ 2nd Sem ☐ Summer

Display Balance

Subject Load	Assessment Record
SOC SCI 1*	3 0 3
SOC SCI 21*	3 0 3

Total Units: 28

Payment

OR Number	Date	Amount
1626162	2015-06-15 14:58:30	2500.0

Account Summary

Total Payable:	12,365.00
Total Payment:	2,500.00
Remaining Balance:	9,865.00

My Bills

School Year: 2015-2016
☒ 1st Sem ☐ 2nd Sem ☐ Summer

Display Balance

Description	Amount
Athletics-College	240.0
CSG Fee-College	50.0
Cultural-College	100.0
Developmental Fee-College	400.0
Guidance-College	100.0
ICT Services	200.0
Insurance	55.0
Internet-College	200.0

F. Offered Subject

Provide the **subject code** of the subject searching for; choose any of the **search filter** desired and enter the **school year** the subject is needed and tap the search button to display the result. Once the result is displayed and the user wants to search other subject, tap the circle shaped search button located on the upper right of the screen.

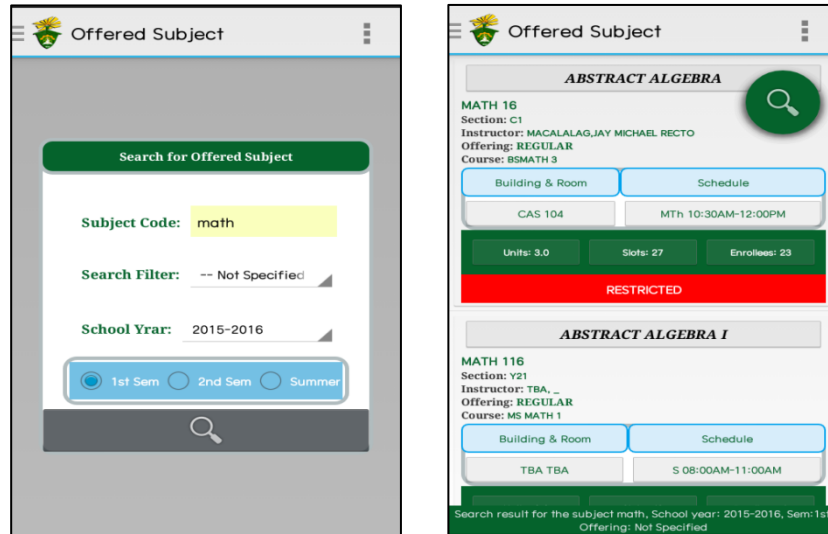

Part 3: Other Options

The user can find the other options by tapping the overflow icon on the action bar which is shown below,

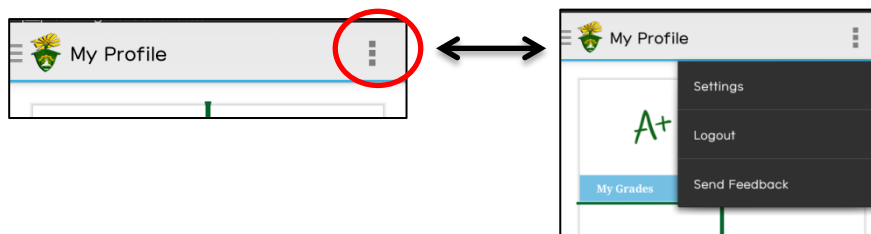

Or if the devices android version is 4.2 below then you can access the option menu using the option button located on the bottom of your device which is shown below.



There are three options the Settings, Logout, and send Feedback. The **Settings** option displays and functions the same as the settings button found on the log-in screen explained on Part 1 Step 2 of this user manual, the **Logout** button is used if the user wants to logout of the application and the **Send feedback** button is used if the user wants to send his/her reviews, comments, error reports and suggestions to the developer of the app for further improvement as shown below.

